

(TO BE INSERTED BY UTILITY)

ADVICE LETTER NO. 126

DEC. NO. 84334

ISSUED BY

O. L. BANZ

NAME

President

TITLE

(TO BE INSERTED BY UTILITY)

DATE FILED

20 1976

EFFECTIVE

25 1976

RESOLUTION NO.

CALIFORNIA-AMERICAN WATER COMPANY
9841 AIRPORT BOULEVARD
LOS ANGELES, CALIFORNIA 90045

CANCELLING

New

C.P.U.C. SHEET NO. 942-W

C.P.U.C. SHEET NO.

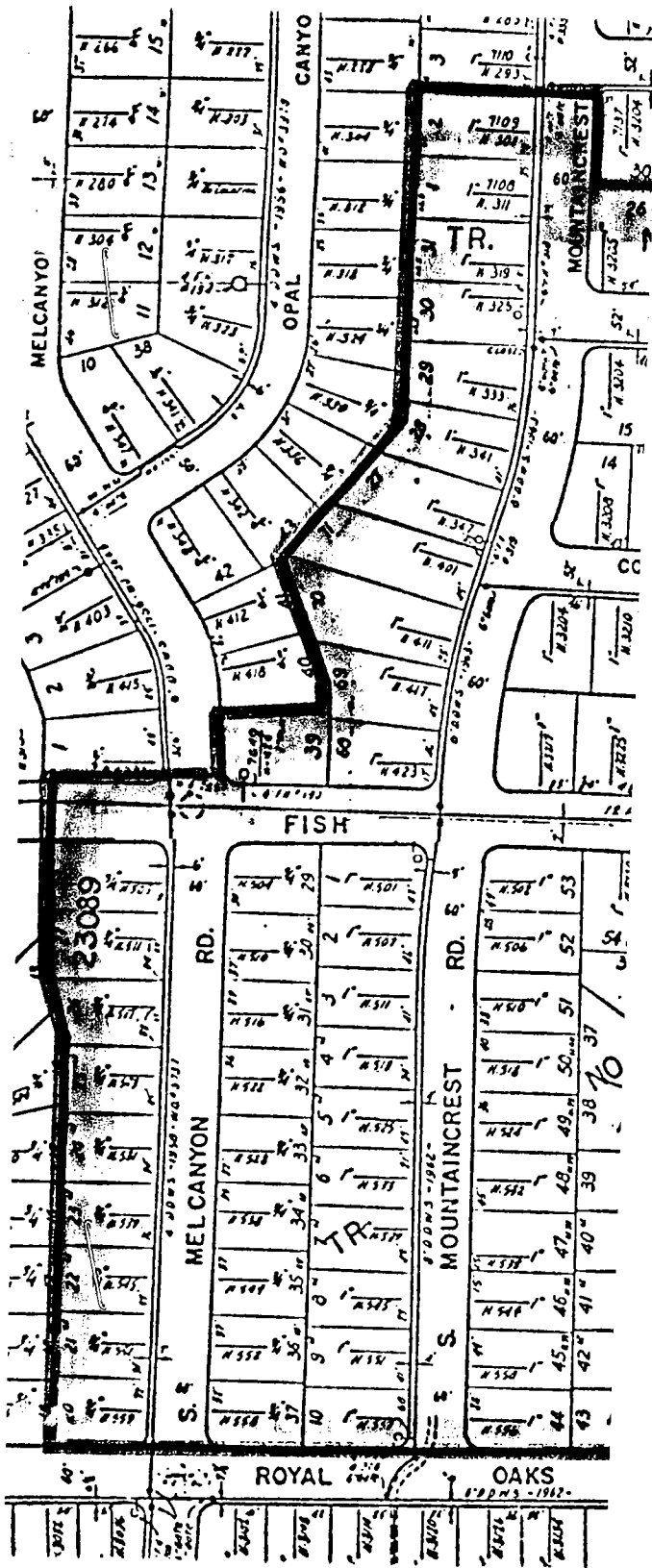

(TO BE INSERTED BY UTILITY)

ADVICE LETTER NO. 126

DEC. NO. 84334

ISSUED BY

O. L. BANZ

NAME

President

TITLE

(TO BE INSERTED BY C.P.U.C.)

DATE FILED MAY 20 1976

EFFECTIVE MAY 25 1976

RESOLUTION NO.

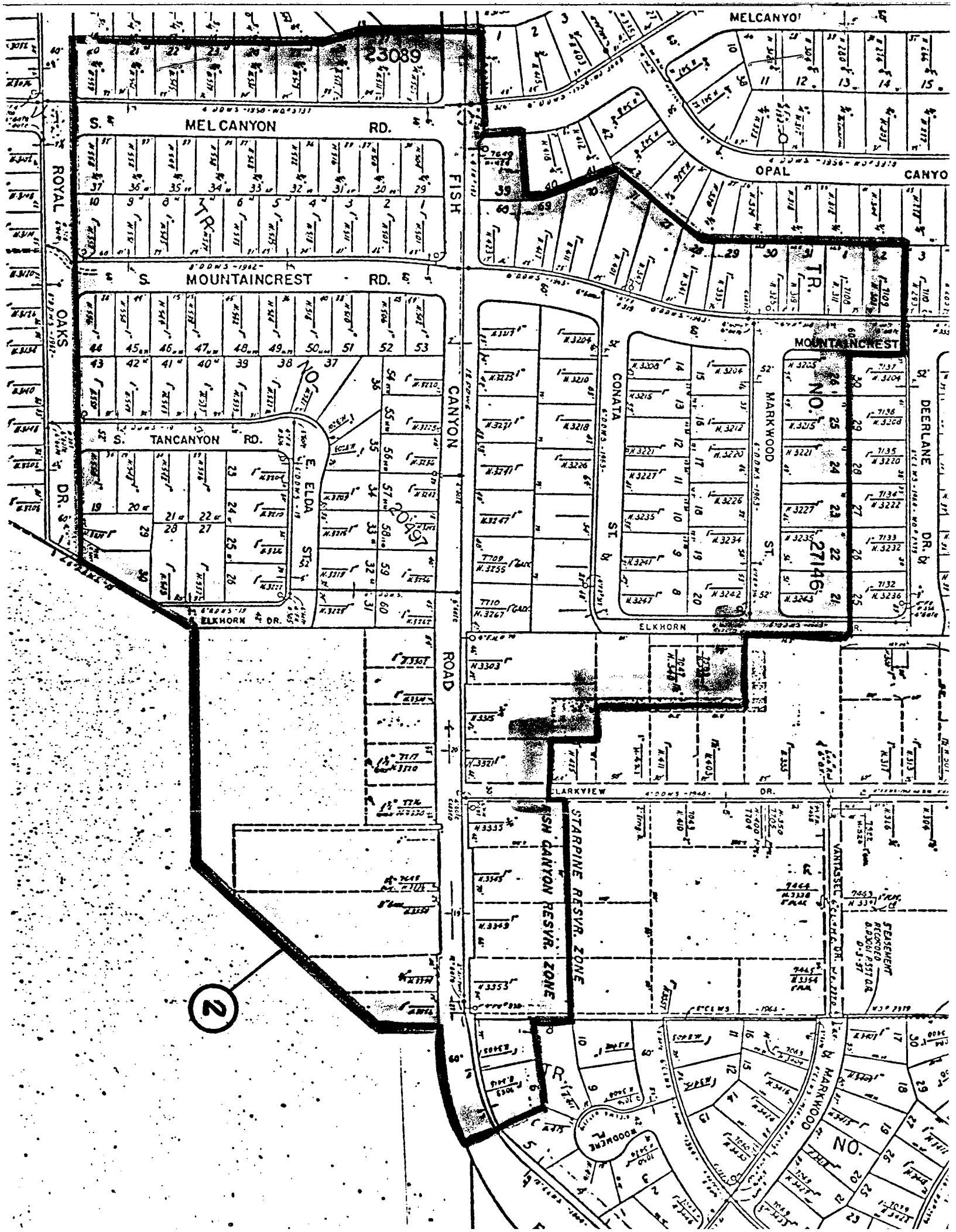

33089

MEL CANYON RD.

MOUNTAINCREST RD.

TANCANYON RD.

ELKHORN DR.

FISH CANYON

CANYON

ROAD

CONANTA ST.

MARKWOOD ST.

LARKVIEW DR.

STARBUCK RESVR. ZONE
FISH CANYON RESVR. ZONE

MELCANYON

OPAL CANYON

MOUNTAINCREST NO. 27146

DEERLANE DR.

DR. B

2

STATEMENT RECORD BOOK P. 57 D-3-37

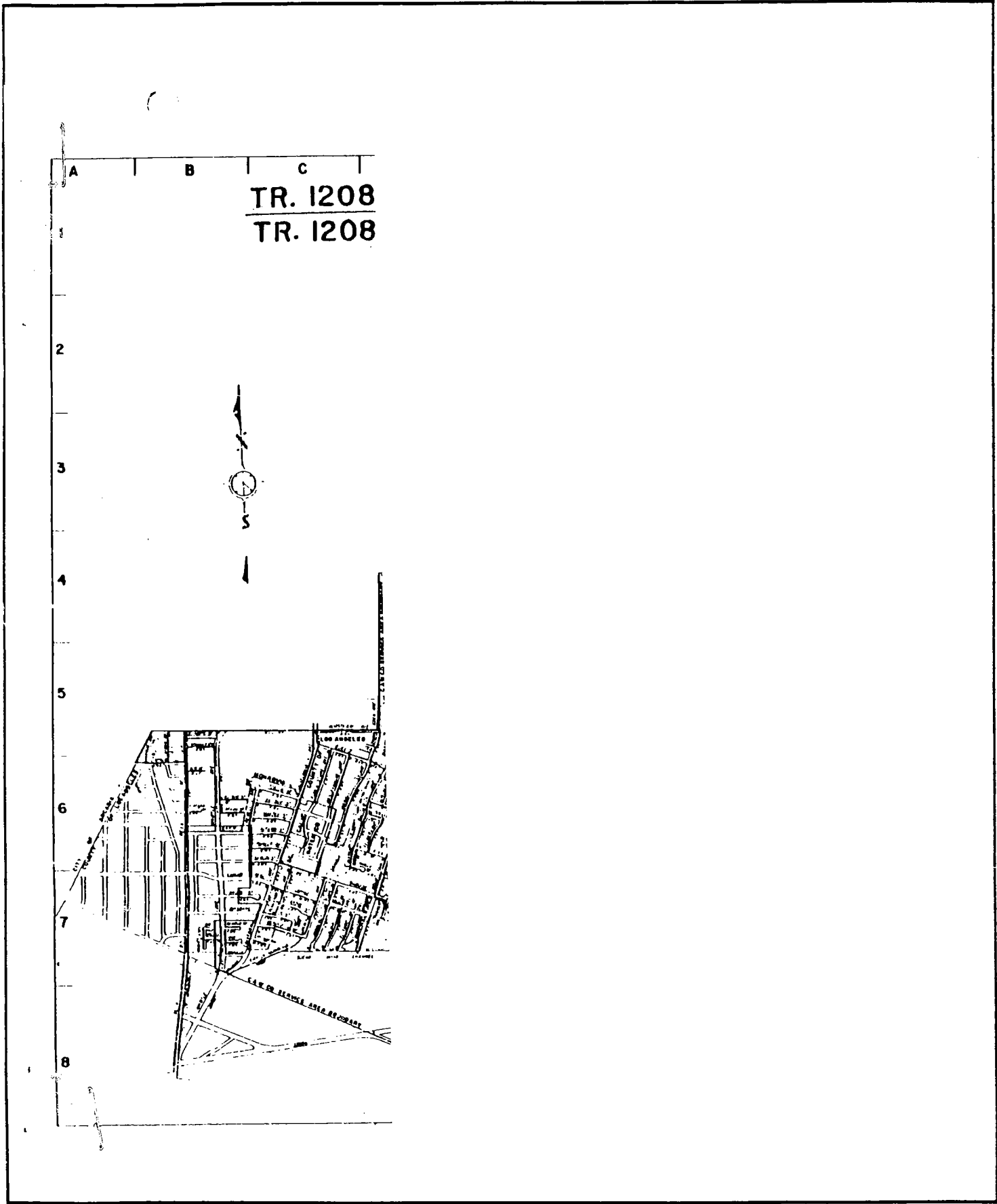

(TO BE INSERTED BY UTILITY)

ADVICE LETTER NO. 275

DEC. NO. _____

ISSUED BY

L. D. Foy

NAME

Vice President - Operations

TITLE

(TO BE INSERTED BY C.P.U.C.)

DATE FILED DEC 7 1983

EFFECTIVE JAN 6 1984

RESOLUTION NO. _____

TR. 12088
TR. 12087

26°
N 0° 20' E

N 89° 51' 35" E

15840' N. LINE SEC. 19, 20, 21 T11N, R. 10W

N 10° 15' 15" E
2400'

TR. 33704

2

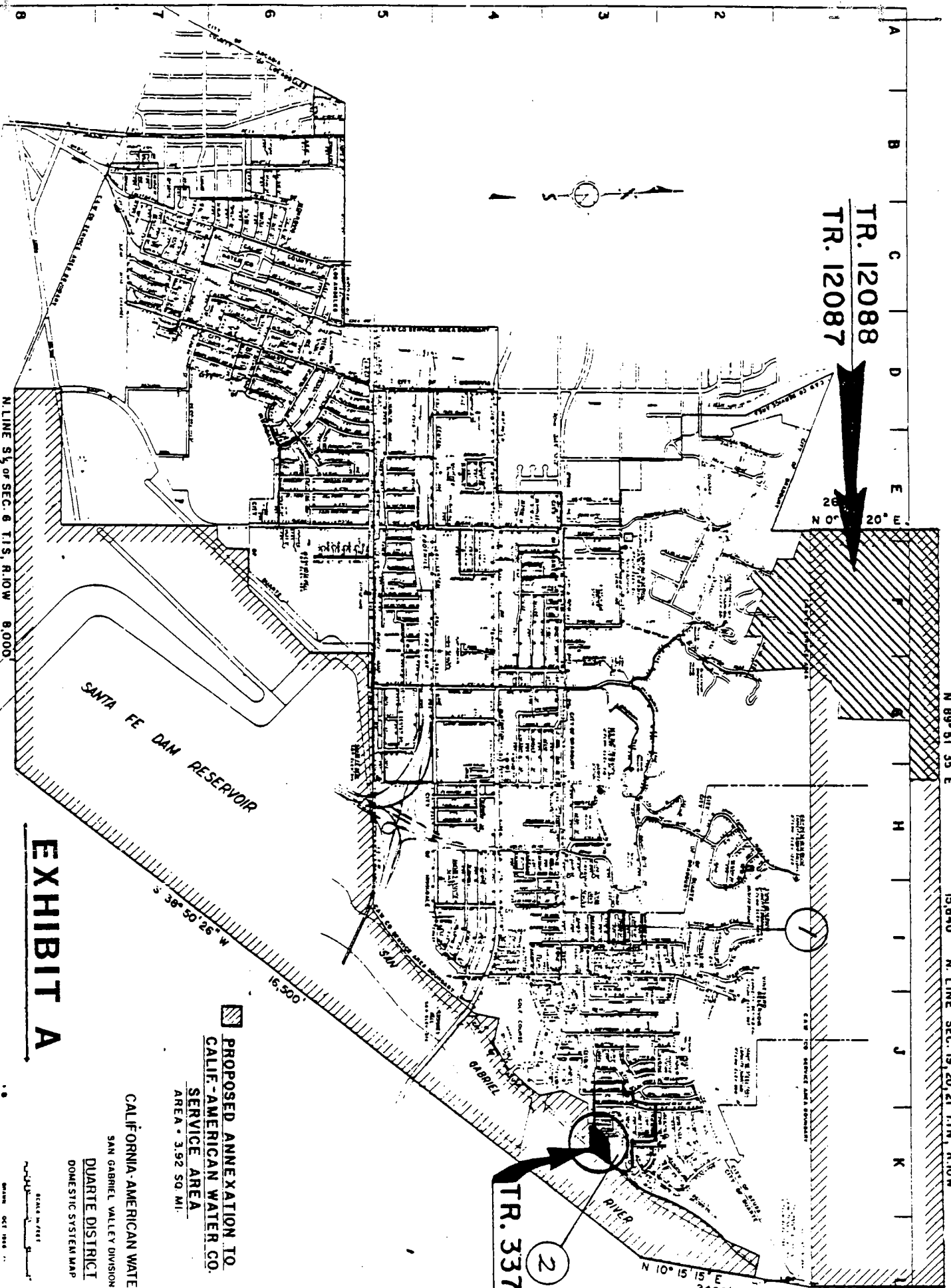
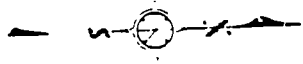

EXHIBIT A

 PROPOSED ANNEXATION TO
CALIF.-AMERICAN WATER CO.
SERVICE AREA
AREA - 3.92 SQ. MI.

CALIFORNIA-AMERICAN WATER CO.
SAN GABRIEL VALLEY DIVISION
DUARTE DISTRICT
DOMESTIC SYSTEM MAP

SCALE 1" = 400'
DRAWN OCT 1948
REVISED OCT 1948

N. LINE S 1/4 OF SEC. 6 T11S, R. 10W 8,000'

N 52° 50' 26" E
3,385.50'

0.0591

NEEDS AREA 1.37 SQ. MI.